

SSM P/N HDR01826
(Option 7256)

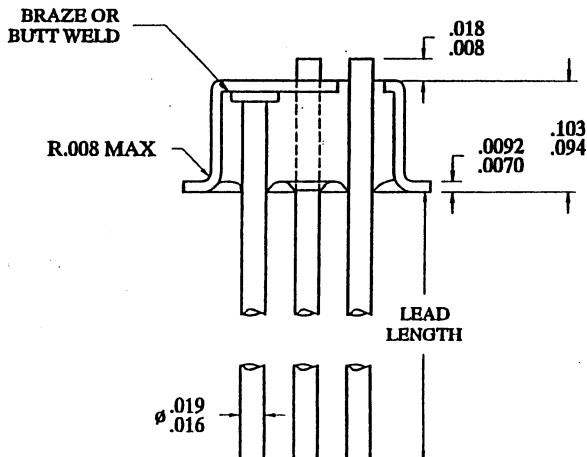
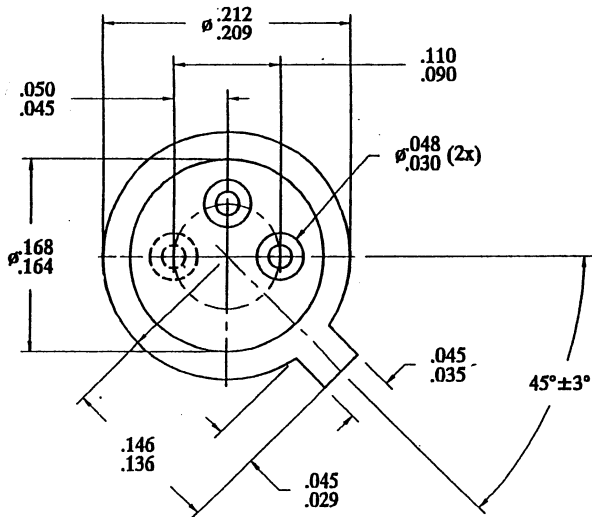

REV.	DESCRIPTION	ECH. NO.	DATE
E	REDUCED SIZE OF DRAWING	MM	6/18/99

CONTROLLED DIST. CODE: OSP-063

NOTES:

- FOR INSPECTION CRITERIA SEE M&SS 72.
- POST HEIGHT AND FLANGE THICKNESS ARE MAJOR ACCEPTANCE LEVELS.
- | CAT. NO. | NI PLATED (μ^2) | | AU PLATED (μ^2) | | LEAD LENGTH |
|----------|-----------------------|----------|-----------------------|-----------|-------------|
| | PRE-FUSED | FINAL | BETA SCOPE MIN. D/A | THRU LDS. | |
| 7256 | | | 40 | NONE | .500/.560 |
| 7218 | | | 30 | FULL | .500/.560 |
| 7218B | | 120 MIN. | 60 | FULL | .500/.560 |
| 7217 | | | 30 | FULL | 1.500/1.562 |
| 7267 | | 50-350 | 30 | 10 | .500/.560 |
| 7271 | | 50-350 | | | .500/.560 |
| 7272 | | 50-350 | FULL | 10 | .500/.560 |
- EYELET SHAPE MUST BE THE SAME FOR ALL SHIPMENTS. A COMMON EYELET SIZE & SHAPE MUST BE MAINTAINED.
- THE GLASS COLOR OF BLACK OR DARK BROWN BE USED.
- MATERIAL: KOVAR.

ALL DIMENSIONS IN INCHES UNLESS OTHERWISE SPECIFIED

M. F. Matheson 3/6/96		DATE	
DRAWN		DATE	
CHECKED		DATE	
APP FOR PRODUCTION		DATE	
FINISH		TITLE	
MATERIAL		SCALE	
SPECIFICATION		SHEET	
		DWG. NO.	

TOLERANCE UNLESS OTHERWISE SPECIFIED: .5 DECIMALS, .02 FRACTIONS, .005 ANGLES, .01 SURFACE SQUARENESS

CATALOG NO.

HEATER, TO-18
(3 LEAD)

1 of 1 B500121

